

mod. RA/SB



TRINCIATRICE PER ESCAVATORI MOD. RA-SB

Trinciatrice robusta e compatta per escavatori medio-piccoli, con potenza minima di 55 HP e peso operativo compreso fra 4 e 7,5 TON. Sono macchine adatte a trinciare erba e arbusti fino a 3-4 cm di diametro, con peculiarità costruttive che le rendono professionali e produttive anche in situazioni di lavoro impegnative. Numerose prove ne hanno confermato le caratteristiche quali:

- telaio monoscocca scatolato
- rotore equilibrato elettronicamente montato su cuscinetti autoallineanti
- mazze tipo P (coltelli ad Y opzionali)
- motore idraulico ad ingranaggi bidirezionale
- trasmissione a cinghie
- rullo di appoggio regolabile
- attacco smontabile ed orientabile costruito su misura
- protezioni antinfortunistiche

TÊTE DE BROYAGE POUR MOD. RA-SB

Tête de broyage compacte pour pelles de moyennes et petites dimensions, avec puissance mini de 55 HP et poids opératif compris entre 4000 et 7500 kg. Il s'agit de têtes de broyage aptes à broyer de l'herbe et des arbustes de 3/4 cm de diamètre, conçues soigneusement afin de les rendre professionnelles et productives ainsi que dans des conditions de travail exigeantes.

Nos nombreux essais nous ont confirmé ses caractéristiques et précisément:

- châssis monocoque à système compact
- rotor équilibré électroniquement et monté sur des roulements autoalignés
- marteaux type "P" (fléaux Y en option)
- moteur Hydraulique à engrainages bidirectionnel
- transmission par courroies
- rouleau palpeur réglable
- attelage démontable et orientable construit sur mesure
- protections de sécurité





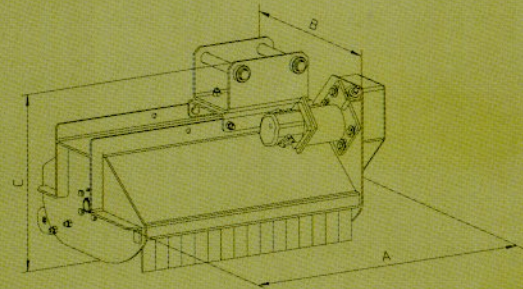
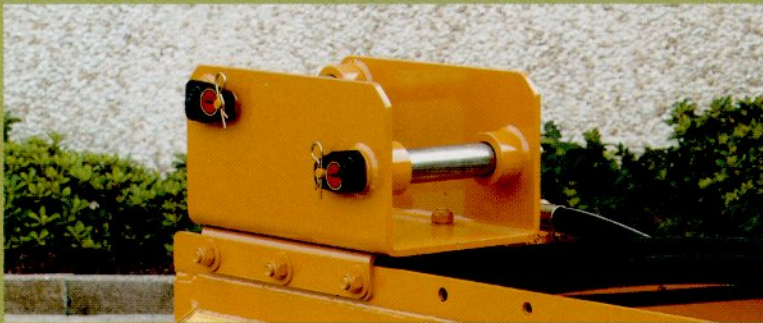

Rullo livellatore regolabile con pulirullo
 Rouleau nivellant et avec décroctoair



Attacco orientabile e smontabile: la macchina può essere posizionata diritta o a 90° rispetto al braccio, oltre ad essere facilmente adattabile a più escavatori.

Attelage orientable et demontable: la tête peut être positionné horizontalement ou en position de 90° verticale face au bras, ainsi que être facilement adaptable à plusieurs models de pelles.

MODELLO MODÉL	Larghezza di lavoro Largeur de travail	A cm	B cm	C cm	 N. coltelli Nombre de fléaux	 Peso Poids KG	 Portata olio richiesta Débit d'huile demandé l/min	 Pressione richiesta Pression demandé bar
RA SB 95	95	113	90	75	8	370	60	180-220
RA SB 115	115	133	90	75	10	390	60	180-220



BERTI Macchine Agricole S.r.l.
 via Musi - 37042 Caldiero (VR)
 tel. 045-6139711 - fax 045-6150251
www.bertima.it - info@bertima.it

Technical characteristics of mulcher Mod. RA SB to be fitted to the arm of excavating machines (40-70 HP / 4,5-7,5 t.)

Mulcher Mod. **RA SB 95** – working width: 95 cm; weight 370 kg
 Oil flow required: 60 l/min - Pressure: 180-200 bar

Mulcher Mod. **RA SB 115** – working width: 115 cm; weight 390 kg
 Oil flow required: 60 l/min - Pressure: 180-200 bar

These machines are suited to mulch anything from grass too branches with a diameter of up to 3-4 cm and are equipped with hitches, pins, electronically balanced rotor with hammers, levelling roller, hydraulic gear motor.

Type of work required:

Grass	Canes	Branches and plants up to 3-4 cm. of diameter
----------------	----------------	--

Working width required (cm)	95	115
-----------------------------	----------	-----------

Data of excavator.

Brand / Manufacturer:	Model:	Power, HP:	Tyre:	Tracked:
--------------------------------	-----------------	---------------------	----------------	-------------------

X (mm)..... If possible, please choose one of the following: 300; 360; 400 mm.
Y (mm) Z (mm)
Data taken from: Arm Bucket
Arm with quick hitch system: <input type="checkbox"/> YES <input type="checkbox"/> NO Type:
Greasers of pins:

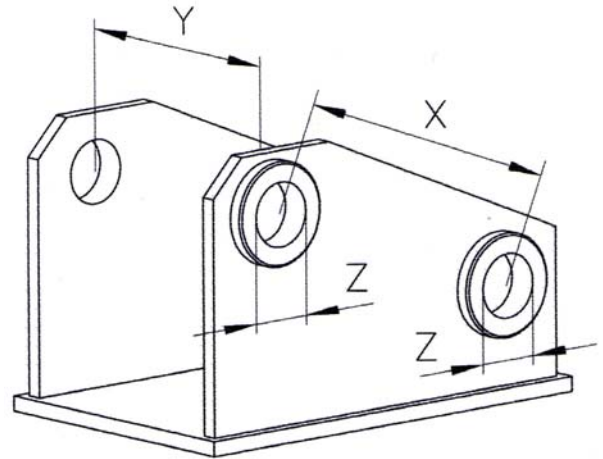

Hydraulic system of the excavator.

The excavator should be equipped with a hydraulic system complete with oil shutter valves. A hose constantly feeds the mulcher according to the above specified capacity and pressure.

Should the excavator be equipped with several pumps, it may be necessary to use all the pumps in order to reach the required oil delivery and pressure.

There should be a unidirectional distributor installed (that makes the oil flow in one direction only) for the feeding of the mulcher and it is only to be used for this purpose.

It is necessary to have such a hydraulic system to ensure maximum performance.

All movements that consume the oil destined to the mulcher must to be avoided, as this would compromise the performance of the mulcher.



BERTI Macchine Agricole S.r.l.
via Musi - 37042 Caldiero (VR)
tel. 045-6139711 - fax 045-6150251
www.bertima.it - info@bertima.it

Hoses.

The excavator must have two hoses (oil delivery and oil return) and a drainage hose:

- the oil delivery hose (Ø 3/4" minimum) must be connected to the distributor; the connector to the mulcher must be type Ø 1" gas male;
- the return hose (Ø 1" minimum) must be connected directly to the oil tank; the connector to the mulcher must be type Ø 1-1/4" gas male;
- the drainage hose (Ø 1/2" minimum) must be connected directly to the oil tank under the oil level itself, or at the top of the tank with a draft hose that has to be constantly under the oil level; the connector to the mulcher must be type Ø 1/2" gas male;

The three hoses have to be long enough to reach a level of about 60-70 cm from the bottom of the excavator arm and, if possible, on the left side of the arm when facing the excavator.

It is good practise to mount some plug cocks at the end of the hoses, in order to avoid oil leakage during the mounting and removing operations.

Hitches.

Made to measure in accordance with the data provided by the customer / dealer.

Safety

The machines are built in conformity with the MACHINES SAFETY STANDARDS and certified with the CE symbol.

Customer's data.

Name of Company:
Address:
Tel: Fax:
Contact's name:
Date: Signature:

NOTES:

.....
.....
.....
.....

**Any order of each of the a.m. implements has to be previously authorized by the Technical Dept. of BERTI Company. Technical data of the relevant excavators have to be supplied by the customer/dealer and approved by BERTI.
BERTI may not be responsible of any failures to the excavators that may occur.**