

NORSE 390, Parts Catalogue

Serial No.: 3900001 →

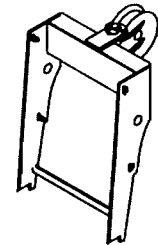

See page 6
If fitted

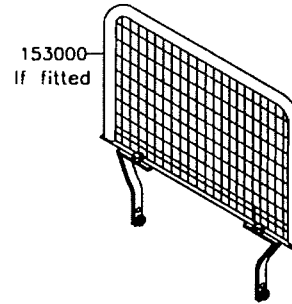
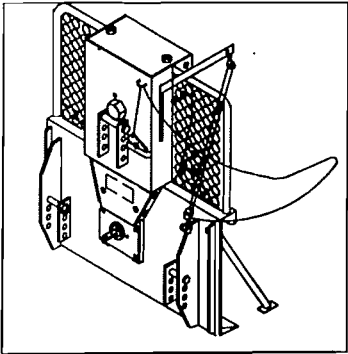
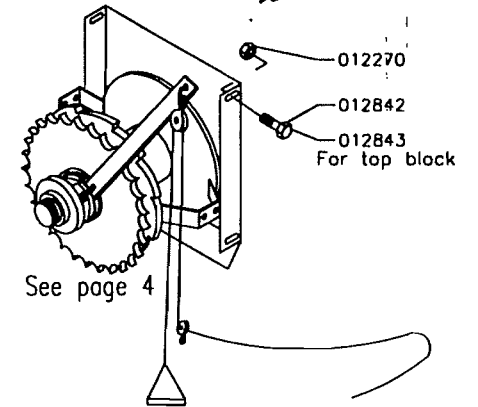

GENERAL INFO:
This Parts Catalogue consists of 12 numbered pages.
This Catalogue: P/N 395002

- Gjengivelse av tekst og tegninger uten tillatelse forbudt.
- Reproduction of text or illustrations without permission is prohibited.
- Eine Wiedergabe von Texten und Zeichnungen ohne unsere Genehmigung ist nicht gestattet.
- Interdiction de toute reproduction de textes ou d'illustrations sans autorisation préalable.

N/A: Not Available

© IGLAND AS

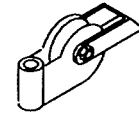
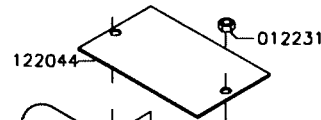

See page 2

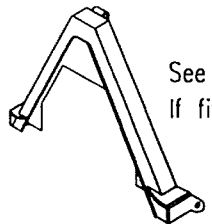

See page 6
If fitted

See page 5

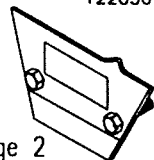

See page 2

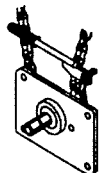

See page 3

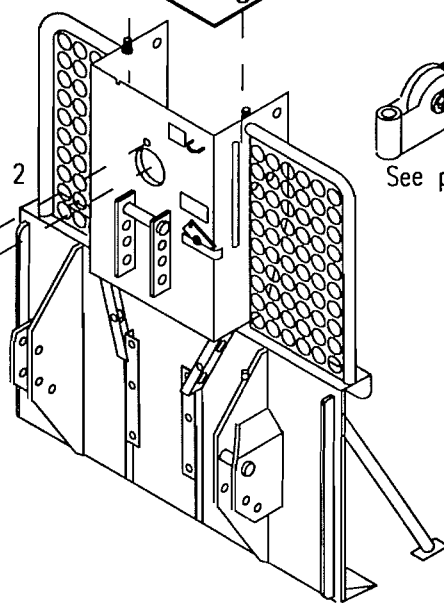

See page 2

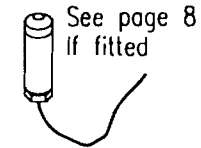

See page 8
If fitted



See page 7
If fitted

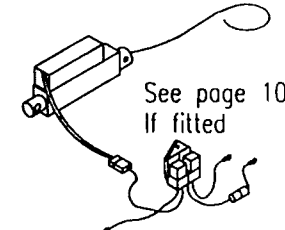

See page 10
If fitted

Approved: K-1.	Revised: 19.11.01
	Issued: AIS 99.04.01.

NORSE 390

BLOCK
RATCHET BRAKE
BOLTS
CHAIN GUARD

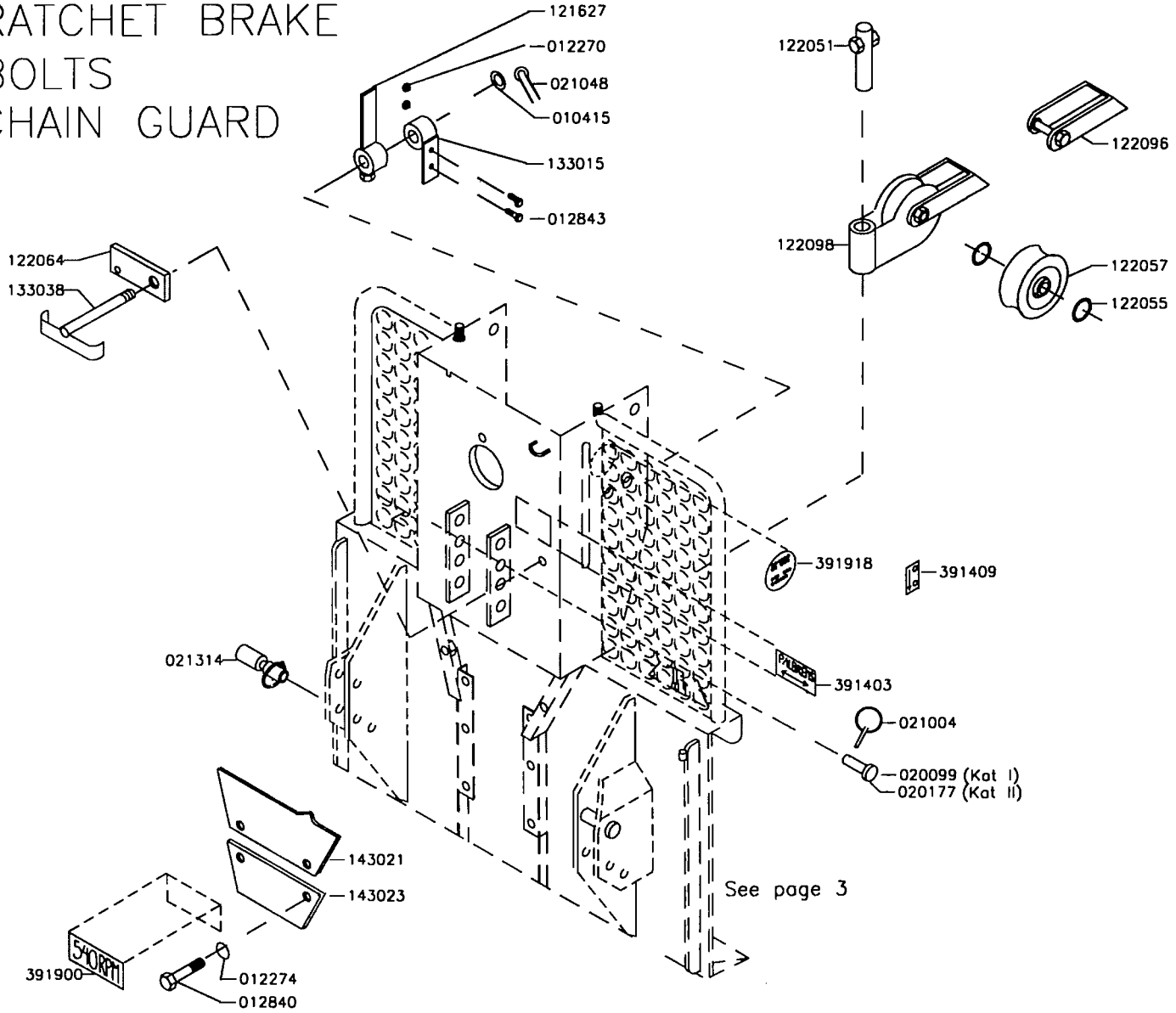
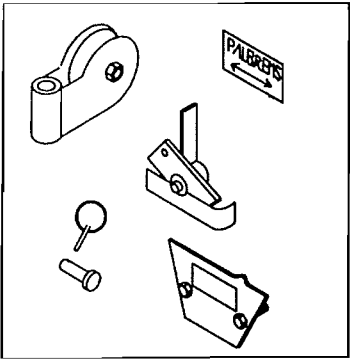

See page 3

NORSE 390

BODY

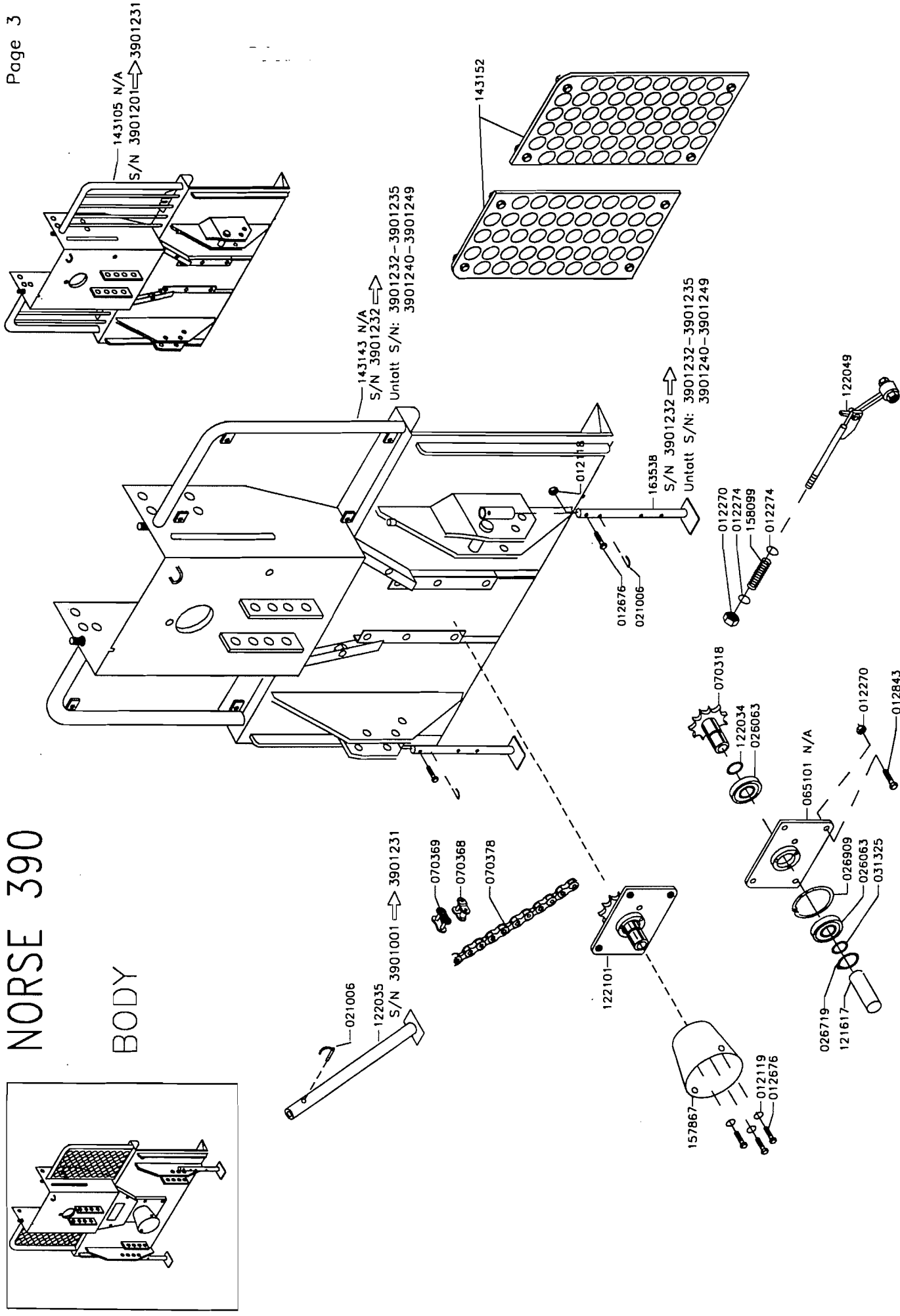
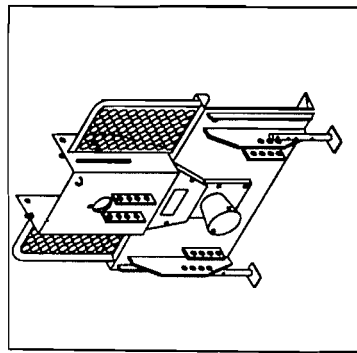

NORSE 390

DRUM

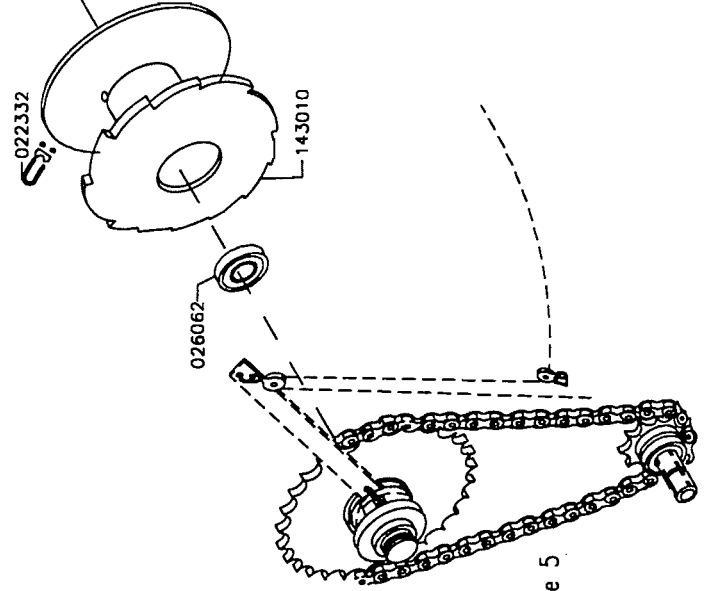
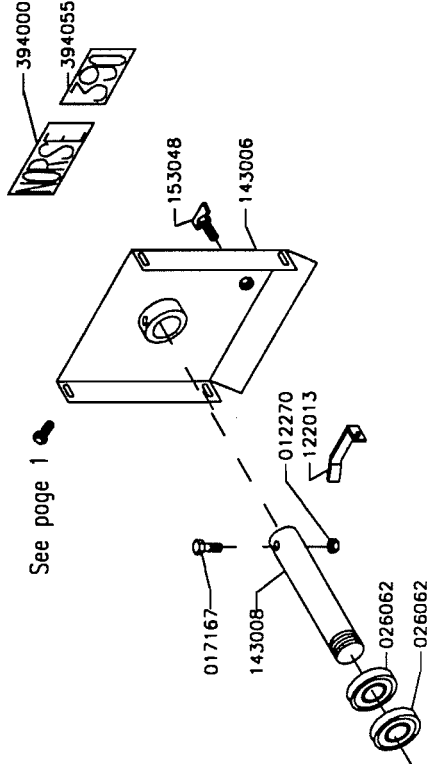
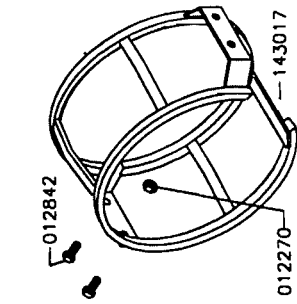
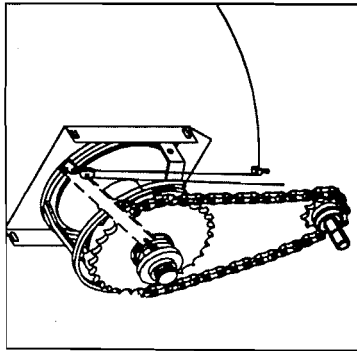

NORSE 390

DRUM

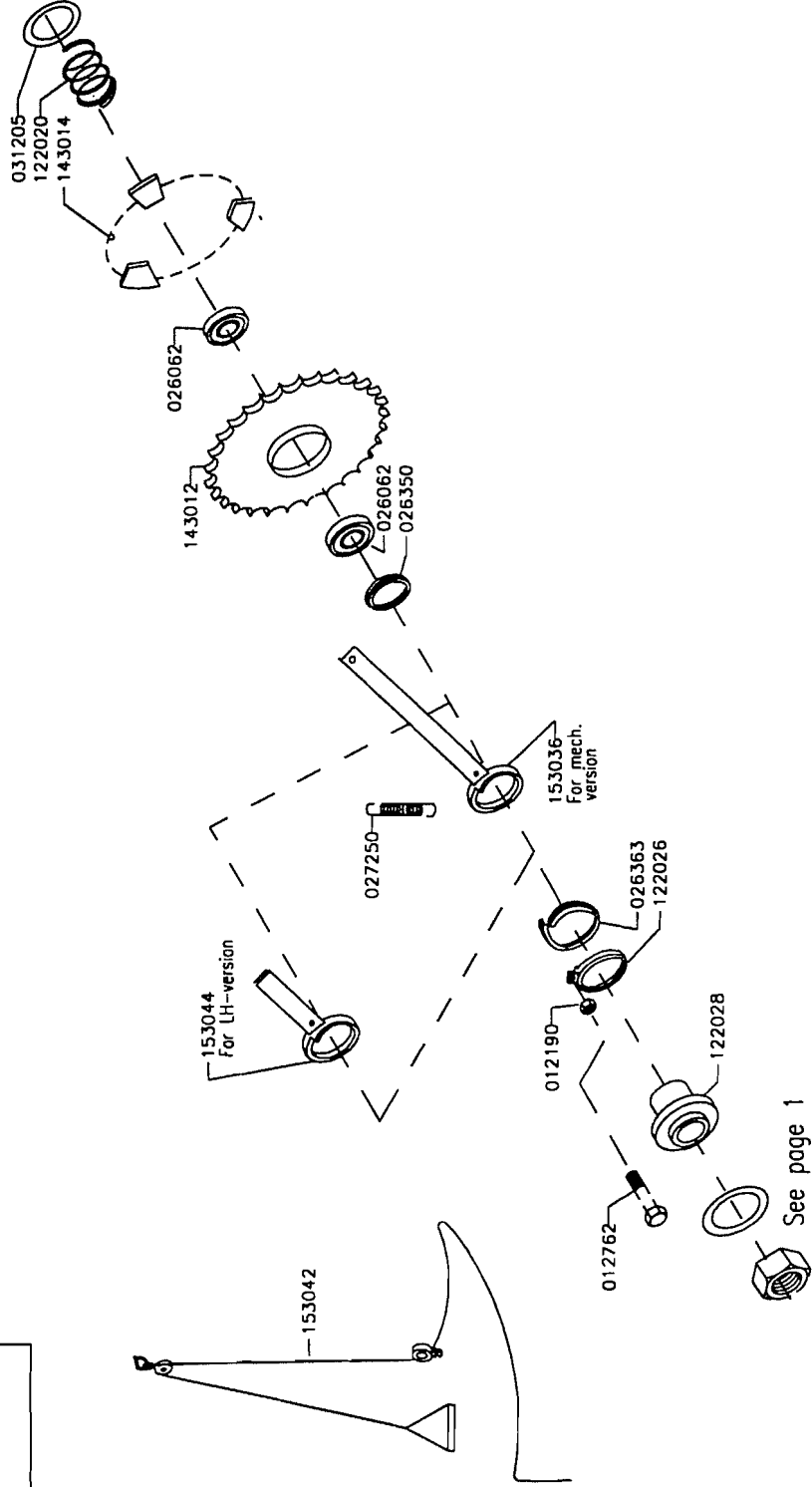
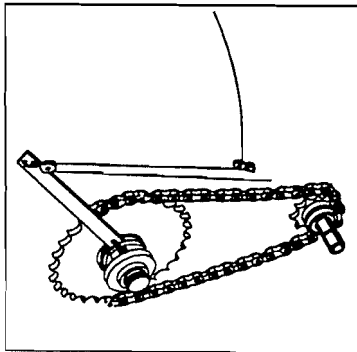

NORSE 390

TOP BLOCK: 143065 if fitted
TRIANGEL SNAP LINK: 153010 if fitted
"HMV" SNAP LINK: 143170 if fitted

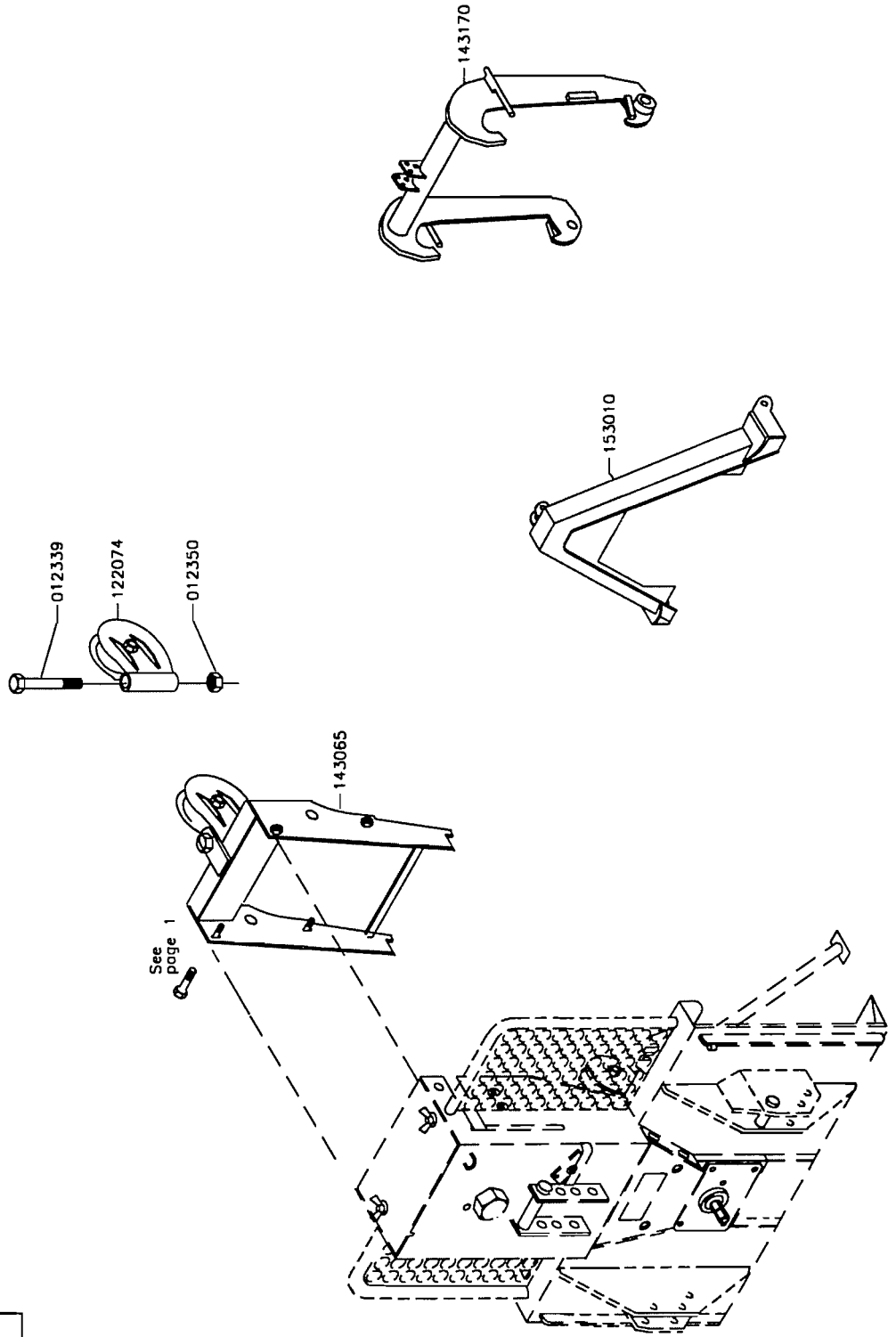
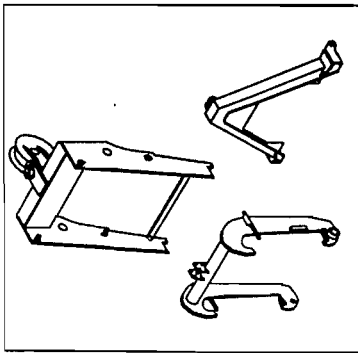

NORSE 390

RADIO REMOTE CONTROL KIT, C/W HYDRAULICS: 095230

Additional price for 4 ch. transmitter/receiver

- 095231

Add. price for frequency for Great Britain/Slovenia

- 091163

(Transmitter, Receiver and Hydraulics)
If fitted.

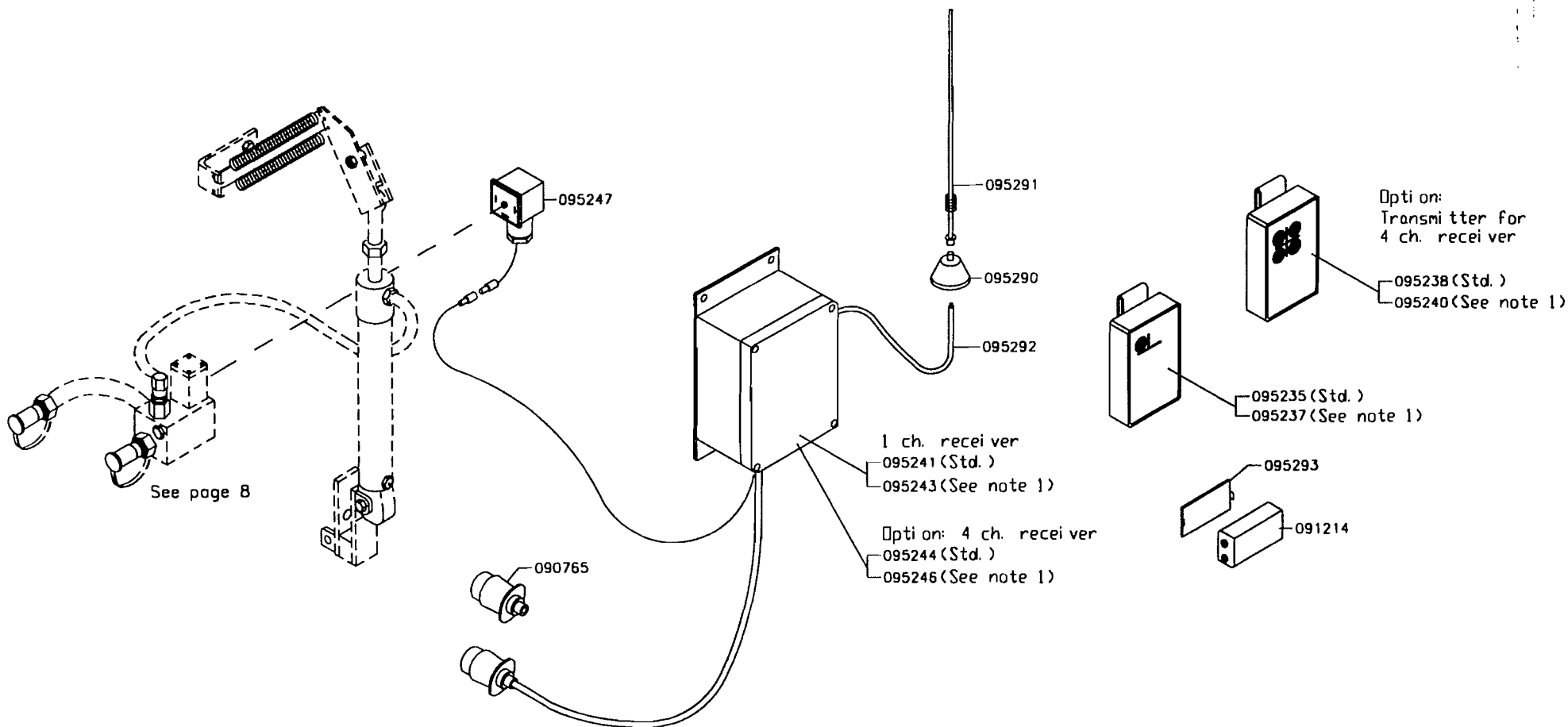
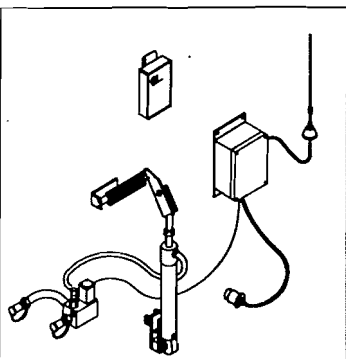

Note 1: Frequency for Great Bri tai n/Sloveni a

NORSE 390

ELECTROHYDRAULIC LOW PRESSURE CONTROL ("LH") (Hydraulic components)

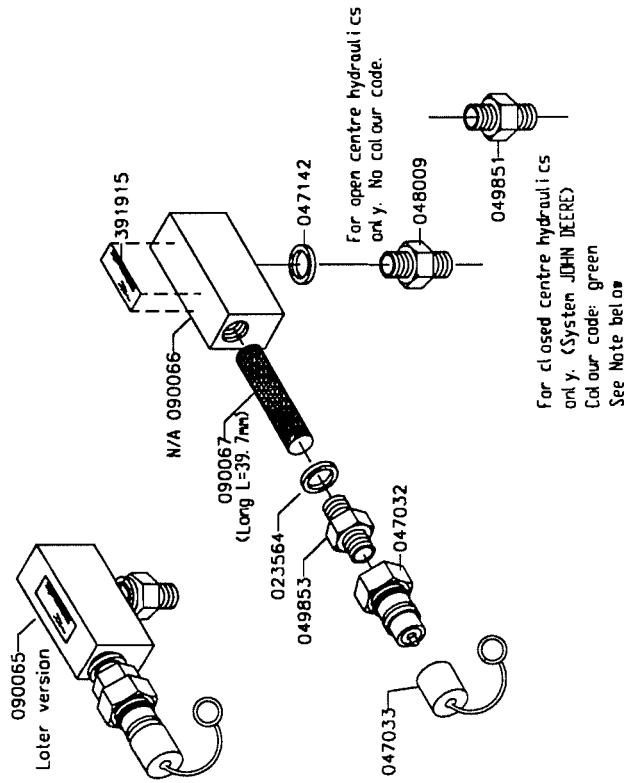
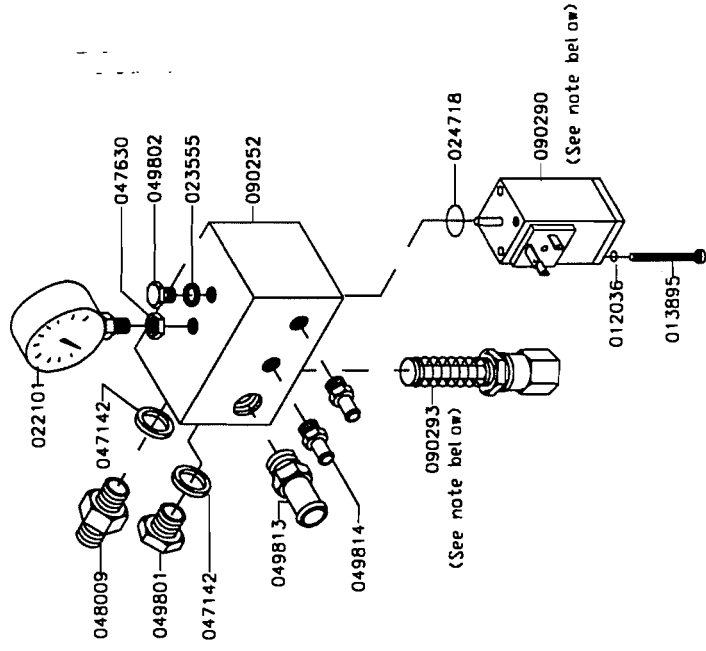
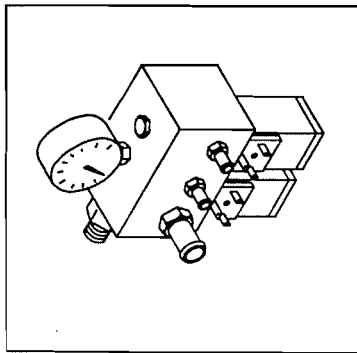

NOTE: Requires special skill on re-installation. If available, see Service Manual.

NORSE 390

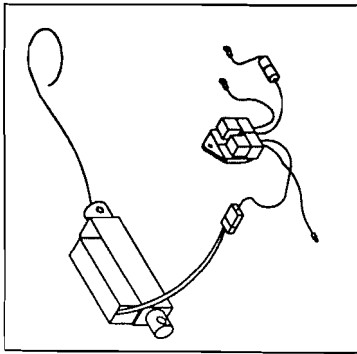

RPM ACTUATOR, compl.: 091442

On/off function

RPM ACTUATOR, compl.: 091443

Stepless function.

If fitted.

Later version

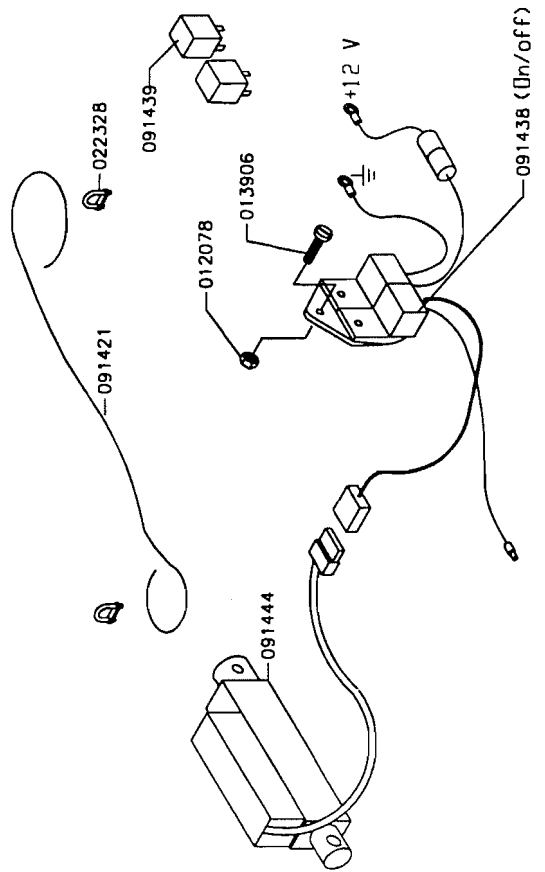

Early version

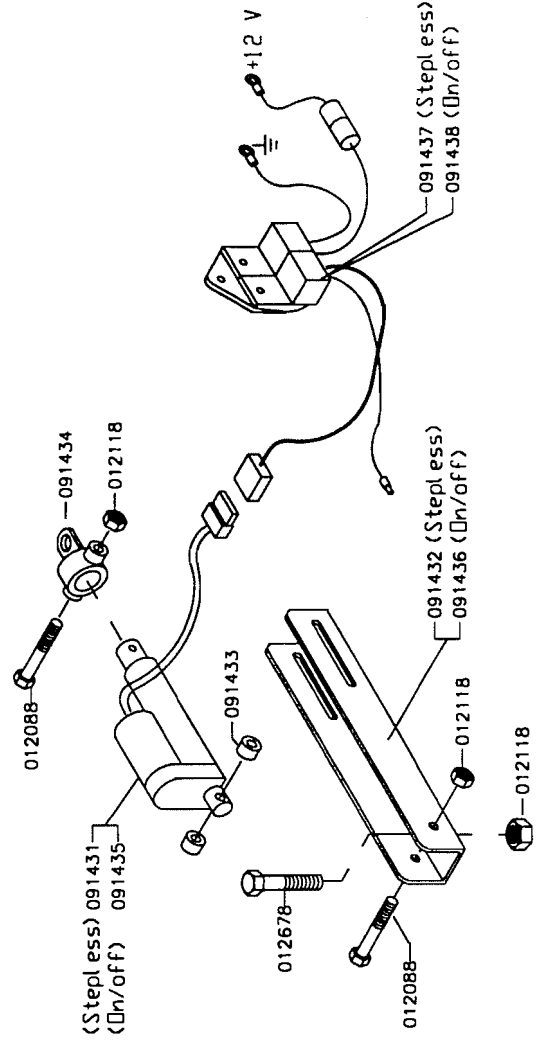

NORSE 390

Miscellaneous

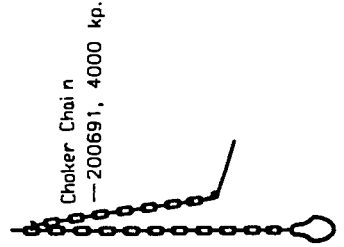
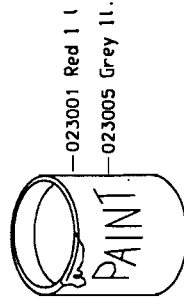
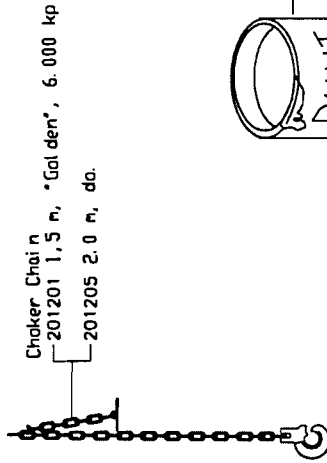
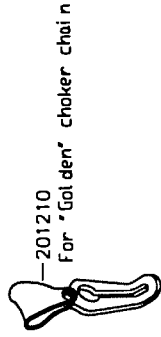
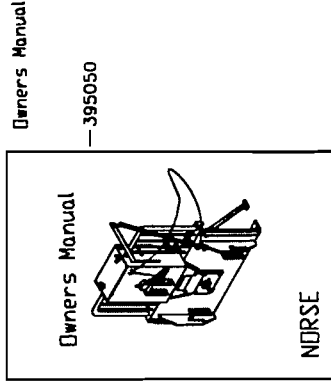
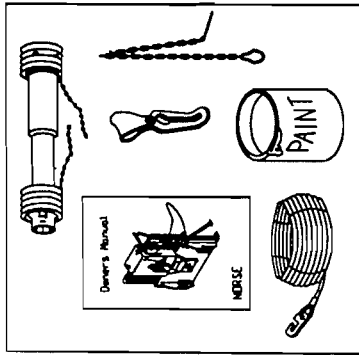

WIRE ROPE, 6x26WS+IWRC 180 kp, 10 mm

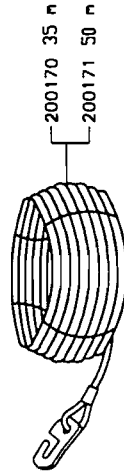

WIRE ROPE, according to ISO 4254-4

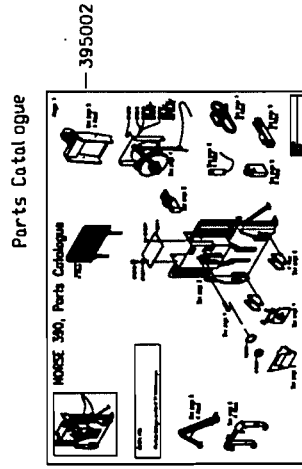
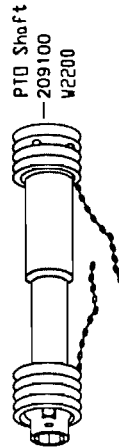

Intentionally blank